

# Meadows Games, Inc.

181 Commercial Street

Sunnyvale, California 94086

Telephone (408) 732-8110

## RECOMMENDED SPARE PARTS LIST FOR FLIM FLAM (Models As Shown)

### MODEL 100 (2 Player)

### MODEL II (2/4 Player)

### GAME TABLE (2/4 Player)

<u>Nomenclature</u>	<u>Unit Price</u>	<u>Nomenclature</u>	<u>Unit Price</u>	<u>Nomenclature</u>	<u>Unit Price</u>
PC Board	\$250.00	PC Board	\$275.00	PC Board	\$275.00
"Flasher" PCB	None	"Flasher" PCB	61.00	"Flasher" PCB	61.00
Counter Assy	9.65	Counter Assy	9.65	Counter Assy	9.65
Joystick Assy	15.95	Joystick Assy	15.95	Joystick Assy	15.95
----	---	-----	-----	Joystick Mtg Plate	4.00
RED Pushbuttons	1.35	RED Pushbuttons	1.35	RED Pushbuttons	1.35
GREEN Pushbuttons	3.75	GREEN Pushbuttons	3.75	----	-----
Harness Assy.	25.00	Harness Assy.	25.00	Harness Assy.	25.00
Lock Set (2 per)	4.40	Lock Set (2 per)	4.40	Lock Set (2 per)	4.40
Coin Box	15.00	Coin Box	15.00	Coin Box	15.00
Coin Acceptor	25.00	Coin Acceptor	25.00	Coin Acceptor	25.00
Tempered Glass	8.00	Tempered Glass	8.00	Tempered Glass	8.00
Plex, Green	10.00	Plex, Green	10.00	Plex, Green	10.00
Motorola CRT	290.00	Motorola CRT	290.00	Hitachi CRT (P-03)	190.00
-----	---	TV Braces	20.00	----	-----
Potentiometers	1.70	Potentiometers	1.70	Potentiometers	1.70
Just. Panel	25.00	<i>— Only via Service Manual</i>			

Other less frequent replacement parts and replacement price can be obtained by calling (408) 732-8110.

### Warranty Information

- (1) PC Board and "Flasher" PCB warranted for one year.
- (2) Monitors warranted for period of 30 days.

Above prices effective 1/20/75  
(Subject to change without notice).

# Trouble Shooting Aids and Adjustment Procedures for Model 100—2 Player Flim-Flam

If the picture rolls vertically, adjust "Vertical Hold"

If the picture breaks up into diagonal lines, adjust the "Horizontal Hold"

If the paddles cross the borders or the net, an adjustment is necessary.

An improper vertical adjustment can cause the paddle to jump or to blink when moved to the bottom position.

When making Paddle adjustments, use the "Pro" size paddles.

## VERTICAL

Top Position: Adjust the pot, part #34, on the Joystick assembly by grasping the two ears on part #33; part #32 **should not be moved**. Rotate part #33 to obtain proper top position.

Bottom position: Move the Joystick to the extreme bottom position and then adjust the potentiometer on the printed circuit board to obtain the proper bottom position. Keep adjusting in one direction until paddle disappears at top of screen, re-emerges at the bottom and then stabilizes.

## HORIZONTAL POSITION

Adjust part #33 on Joystick assembly to obtain the proper position, this effects only the right extreme position of the paddle. Tightness of the Joystick shaft can be adjusted by tightening or loosening screws #1.

## POTENTIOMETER REPLACEMENT

Remove screws #24 and lift off the side with the bail and pot. Then slide the part #13 off the potentiometer shaft. Next remove nut, #21, and washer, #22. Slide potentiometer out of part #33. Install new potentiometer in part #33; then install washer, #22, and nut, #21. Slide part #13 with bail, #14, on the potentiometer shaft, being careful to line up flat on the potentiometer shaft. Install the side assembly on the Joystick assembly using screws #24.

Care should be taken to replace parts in the same order and position as they were when they were removed.

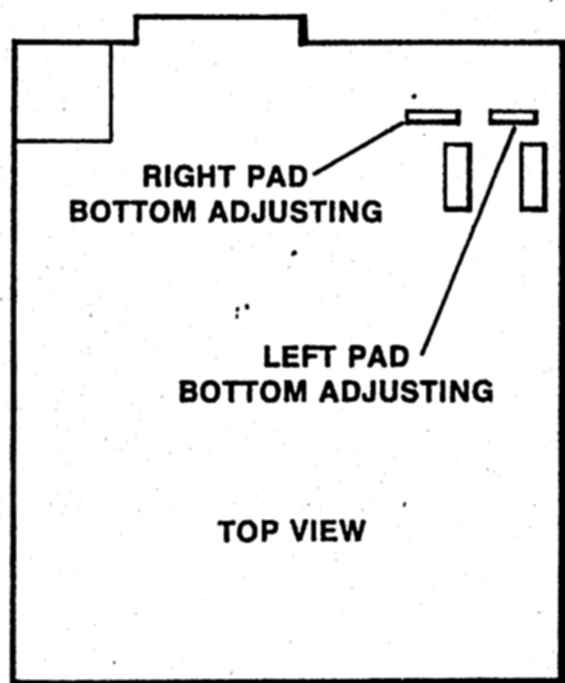

**PRINTED CIRCUIT BOARD**

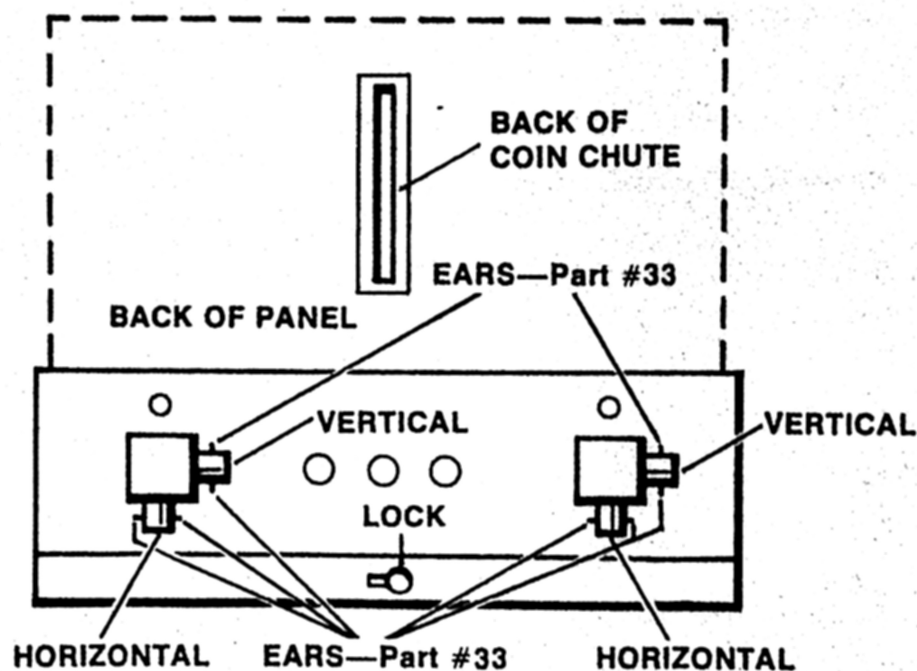

**DOOR ASSEMBLY Adjusting Part #33**

See Other Side for Harness Diagram, Joystick Assembly and Adjustment Locations.

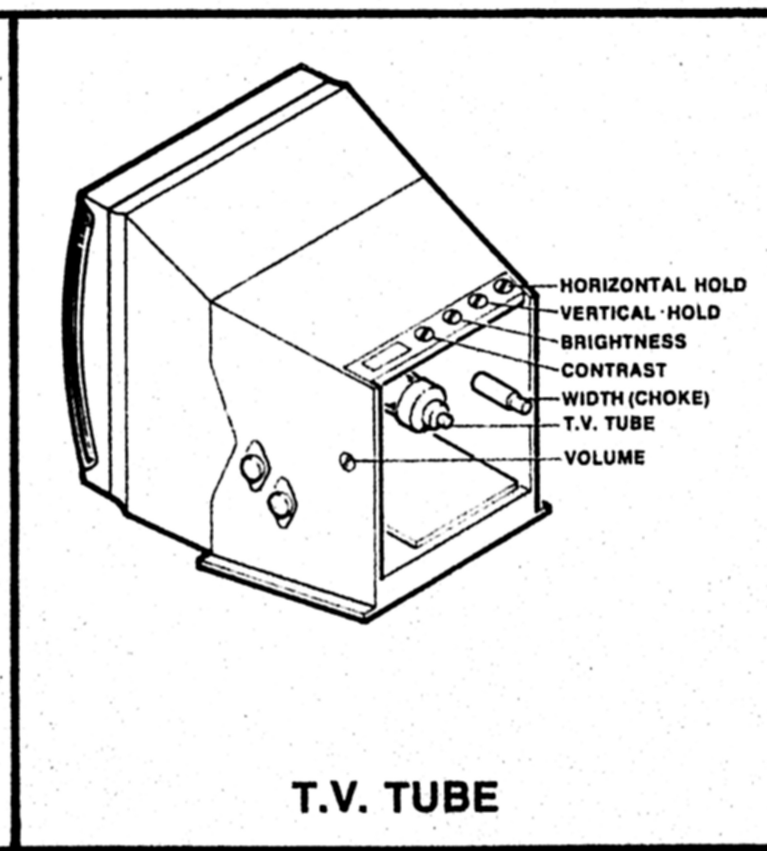
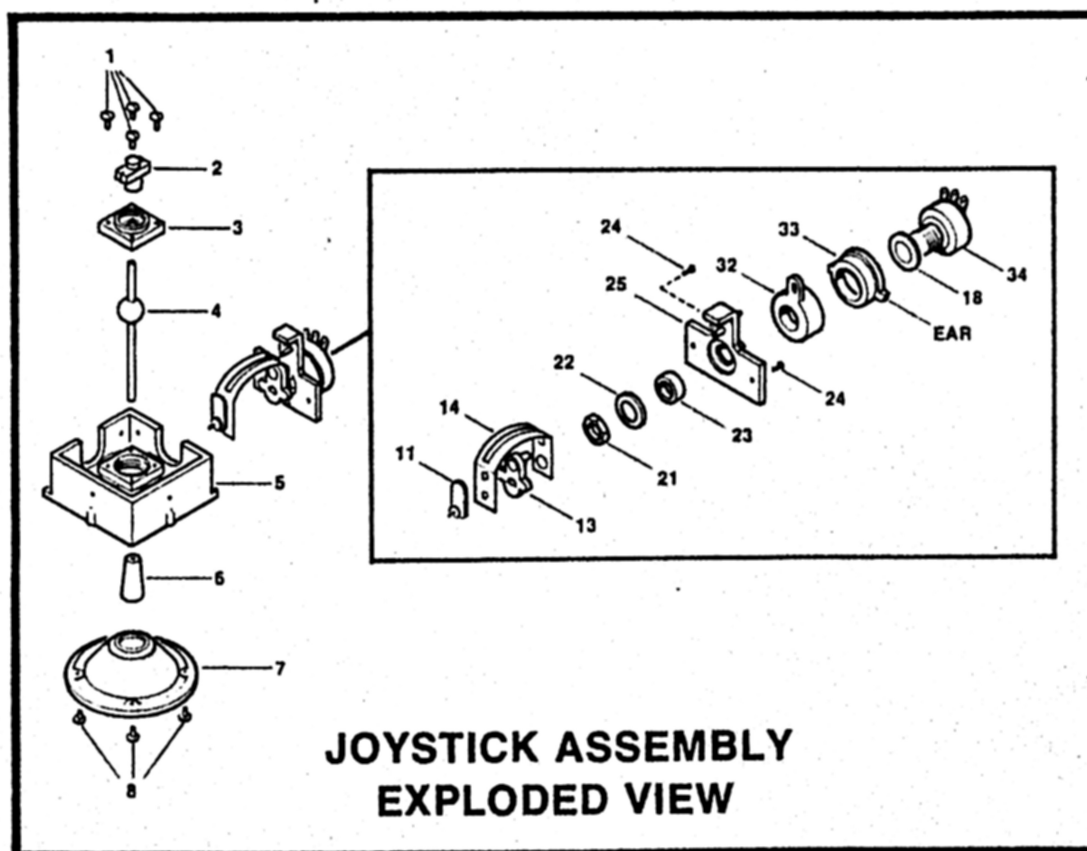
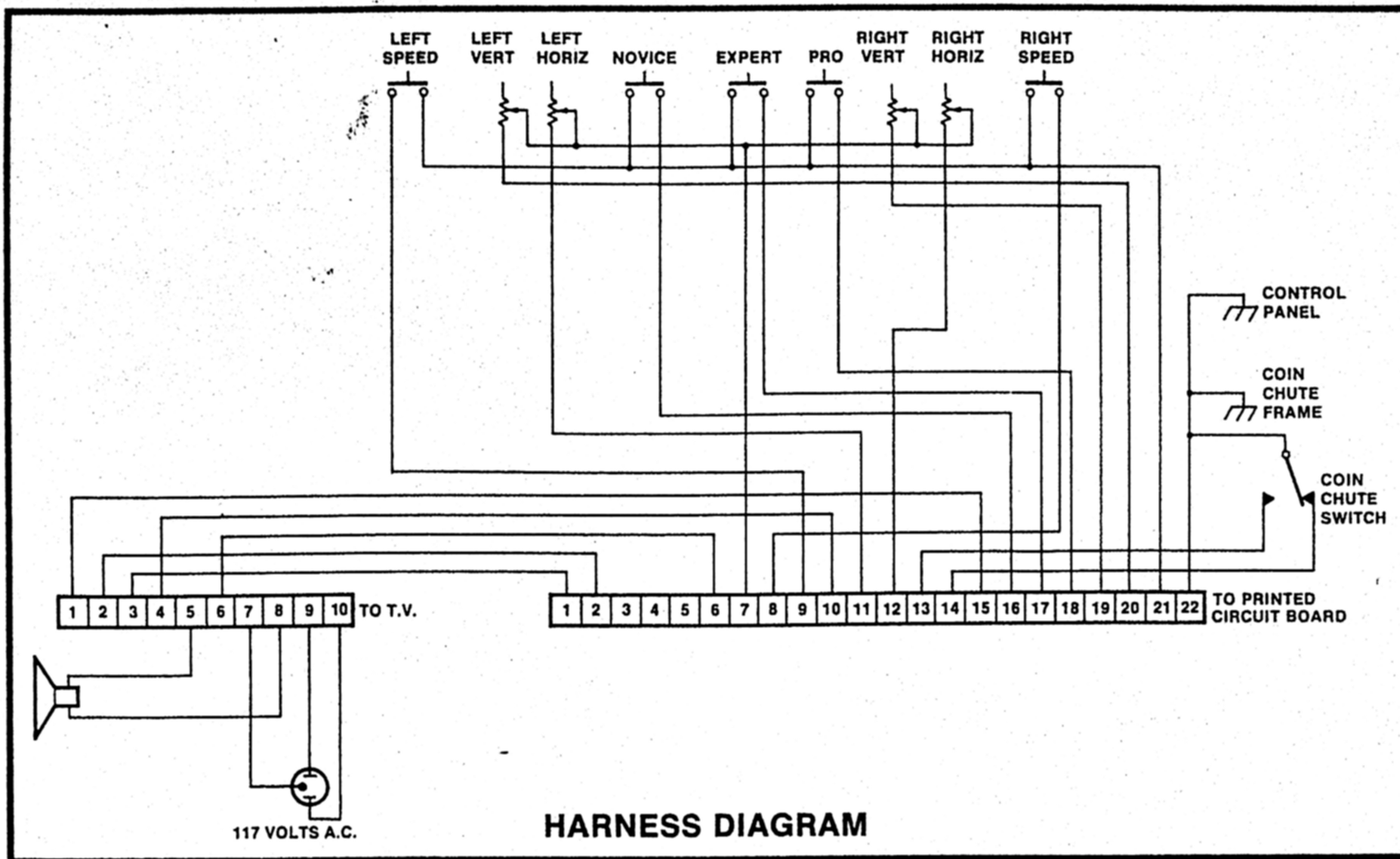

**MEADOWS GAMES, INC.**  
181 Commercial Street—Sunnyvale, Calif. 94086





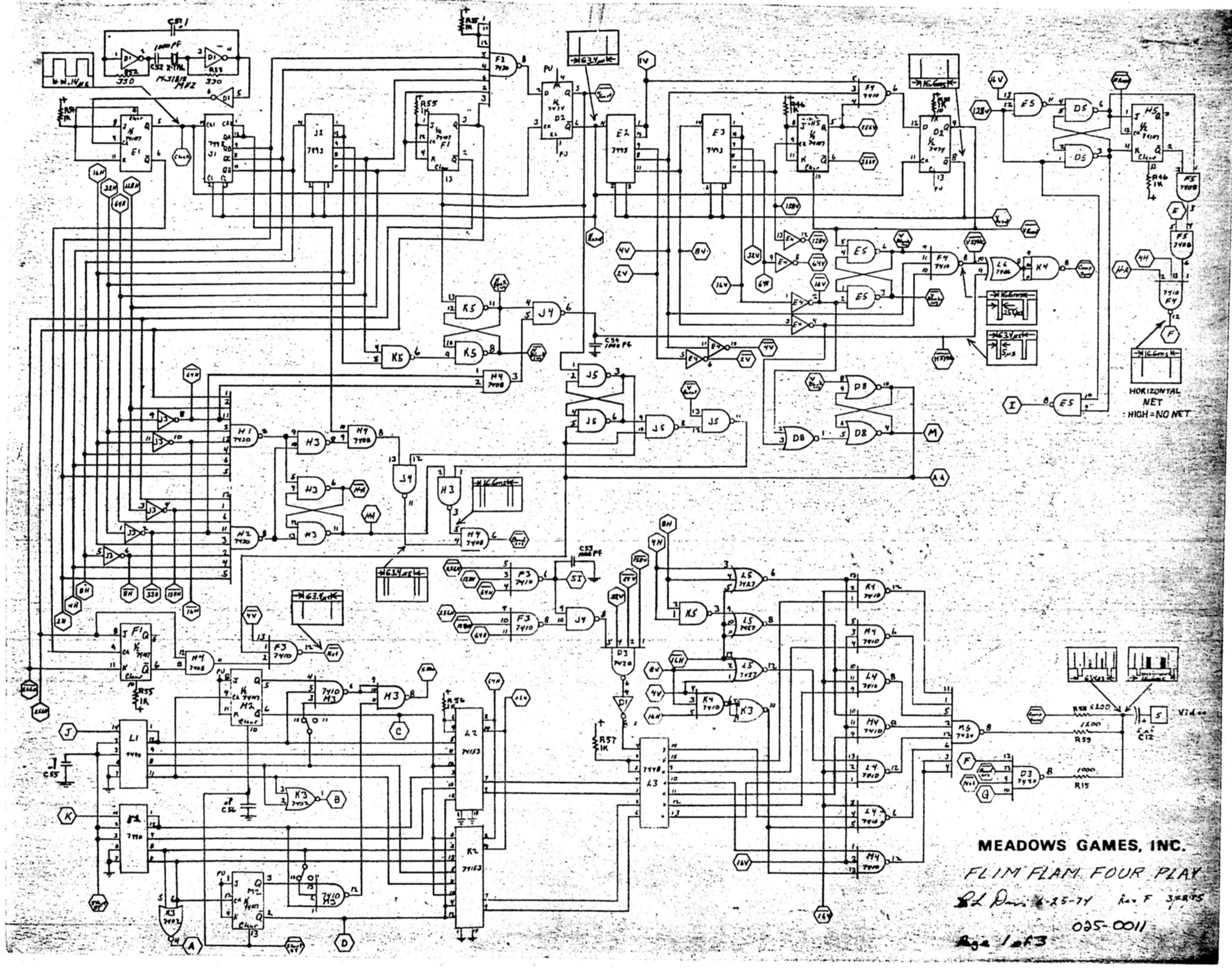

MEADOWS GAMES, INC.  
 FLIM FLAM FOUR PLAY  
 Rev. F 3/8/75  
 025-0011

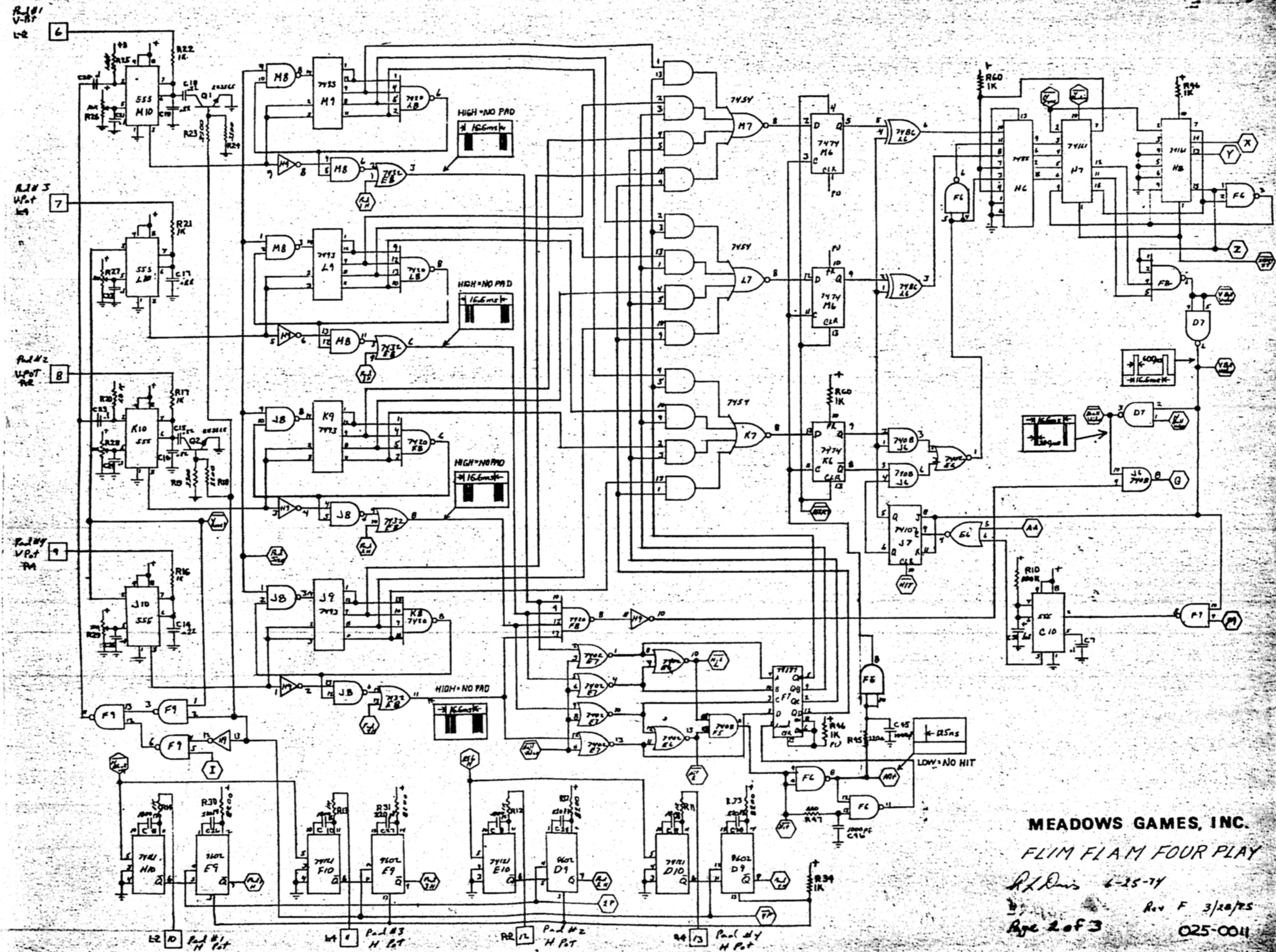

**MEADOWS GAMES, INC.**  
**FLIM FLAM FOUR PLAY**  
 R.D. Davis 6-25-74  
 Rev F 3/20/75  
 Page 2 of 3  
 025-004

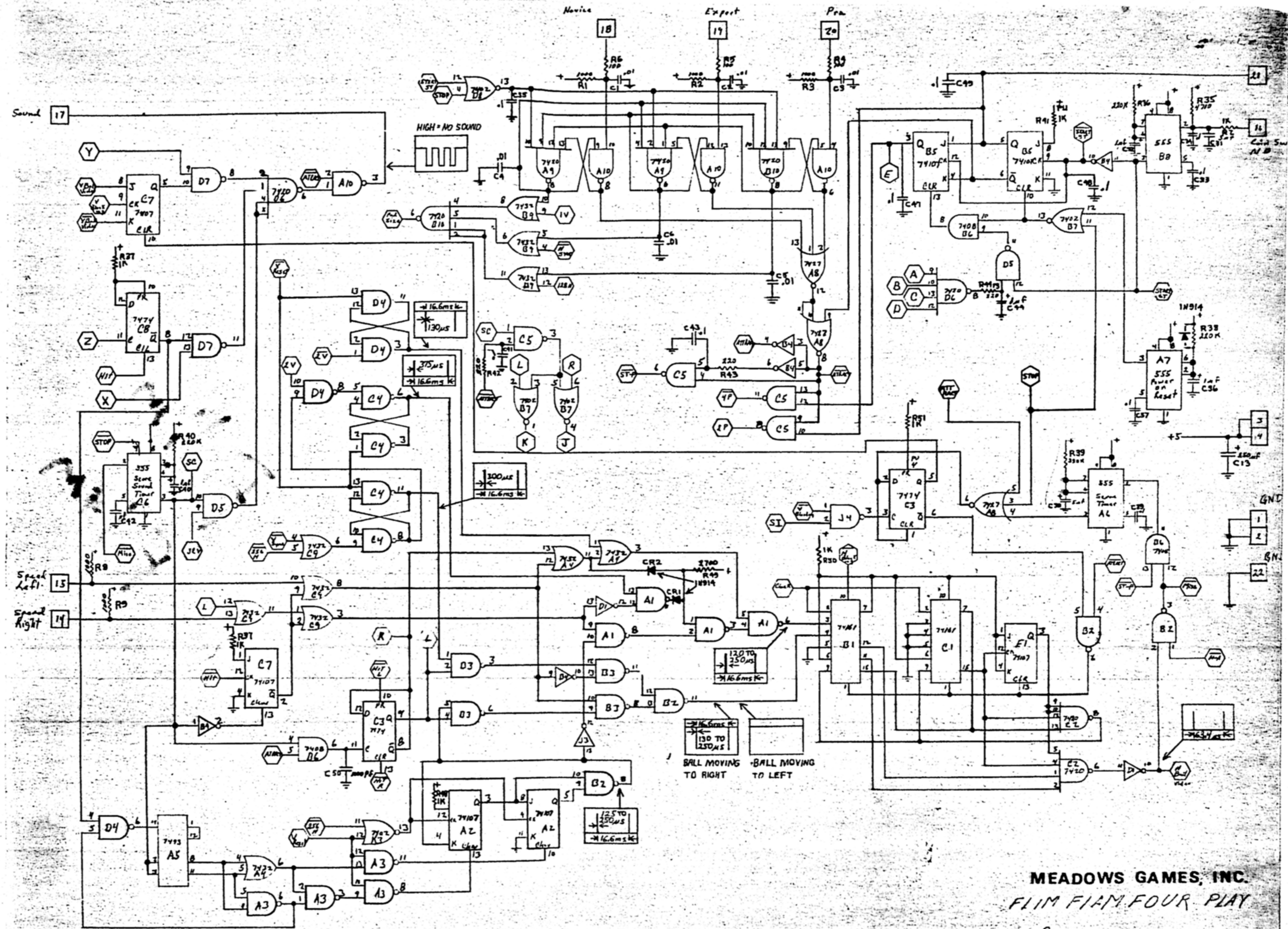

MEADOWS GAMES, INC.  
 FLIM FIAM FOUR PLAY  
 R. L. Davis 1-25-77  
 Rev. F 3/16/77  
 Page 3 of 3 OAS-0011